



Manufacturer

Customer

VEM motors GmbH - Werk Wernigerode
Carl-Friedrich-Gauß-Straße 1

38855 WERNIGERODE
Deutschland

Three-phase motors with squirrel cage rotor,
Housing grey cast iron

Type	IE3-W43R 132 M4	TPM HW
Design output	(kW)	7,5
Design torque	(Nm)	49
Class IE	[-]	IE3-90,5%
Efficiency determination		EN 60034-2-1
Duty type		S1
Design frequency	(Hz)	50
Design speed	[rpm]	1470
Voltage	(V)	500
Connection	[-]	D
Current	[A]	12.8
Relative pull-in current	[-]	7,6
Relative starting torque	[-]	3
Relative pull-up torque	[-]	2,6
Relative pull-out torque	[-]	3,9
Efficiency100/75/50 %	[%]	90,5 / 90,5 / 89,2
Power factor	[-]	0,75
Th. cl.		155(F/B)
Coolant temperature	(°C)	-20°C...+40°C
Altitude above sea level	(m)	1000m
Degree of protection IP		IP55
Moment of inertia	(kgm ²)	0,035
Motor weight	(kg)	88
Bearing, D-side		6308 ZZ C3
Bearing, N-side		6308 ZZ C3
Relubrication interval	(h)	
Grease type		ASONIC GHY 72
Grease amount	[cm ³]	
A-sound pressure level	(dB)	60

Options

Type of mounting	IM B3
Flange	-
Terminal box	Standard
Position of terminal box	on the top
Cable gland	Sealing plug
Position of cable entry	right
Shaft	Standard, 1 shaft end
Bearing	Easy bearing arrangement
Special details to bearings	Fixed bearing, N-side
Winding protection	1 set ptc resistors
Limit values to vibration velocity	Class A
Colour system	Balancing with half key
Delivery conditions and/or official regulations:	01 Moderate (KK C2),RAL 7031 blue-grey IEC / EN 60034-1

This document was produced electronically, all specifications are valid only after confirmation of the manufacturer

Data sheet

04.08.2022 MADE WITH VEM EKAT 2022



Three-phase motors with squirrel cage rotor,
Housing grey cast iron

IE3-W43R 132 M4 TPM HW

Mounting position

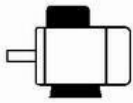

Type of mounting: IM B3
Flange: -
Position of terminal box: on the top
Brake type:
Forced-ventilation:

Terminal box: KK 25 A
Cable gland O: 1 x Sealing plug

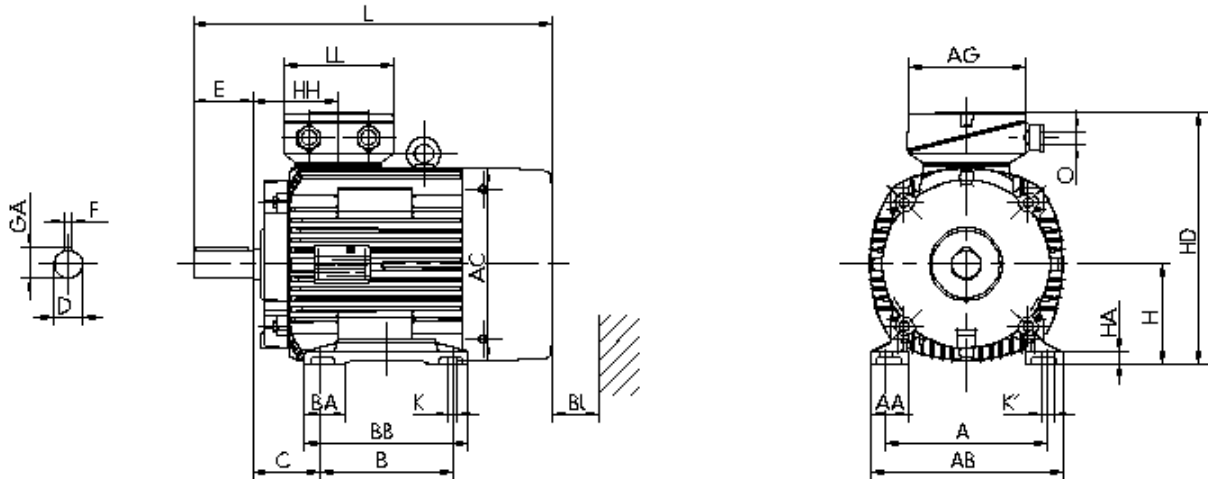

Motor

A	AA	AB	AC	AD	B	B'	BA	BA'	BB	C	CA	K	K'	
216	50	256	258	-	178		53	-	218	89	-	12	12	
Protection cover													Terminal box	
L	LC	H	HA	HD	HH	BI	L	AG	LL	BE	AH			
529	-	132	15	331	114	40	-	156	145	-	-			

Flange

P	N	LA	M	T	S	Tolerances							
-	-	-	-	-	-	H	N	D	DA				
						-0,5	j6	k6	k6				

Shaft-DS

D	E	GA	F	DB
38	80	41	10	DIN 332 DS- M12

Shaft-NS

DA	EA	GC	FA
-	-	-	-

DB...Centre hole

Delivery conditions and/or official regulations: IEC / EN 60034-1

This document was produced electronically, all specifications are valid only after confirmation of the manufacturer